

FEATURES

- 1). Interdigitated amplifying gates
- 2). Fast turn-on and high di/dt
- 3). Low switching losses

| | |
|-------------------|------------------|
| $I_{T(AV)}$ | 1765A |
| V_{DRM}/V_{RRM} | 1900~2500V |
| t_q | 50~80 μ s |
| I_{TSM} | 22.7KA |
| I^2t | 2576 $10^3 A^2S$ |

TYPICAL APPLICATIONS

- 1). Inductive heating
- 2). Electronic welders
- 3). Self-commutated inverters



THE MAIN PARAMETERS

| SYMBOL | CHARACTERISTIC | TEST CONDITIONS | $T_J(^{\circ}C)$ | VALUE | | | UNIT |
|------------------------|--|--|------------------|-------|------|----------------|-------------------------|
| | | | | Min | Type | Max | |
| $I_{T(AV)}$ | Mean forward current | 180° half sine wave 50Hz Double side cooled, $T_{hs}=55^{\circ}C$ | 125 | | | 1765 | A |
| V_{DRM} V_{RRM} | Repetitive peak off-state voltage Repetitive peak reverse voltage | V_{DRM} & V_{RRM} , $t_p=10ms$ V_{DSM} & $V_{RSM} = V_{DRM}$ & $V_{RRM} + 100V$ | 125 | 1900 | | 2500 | V |
| I_{DRM} I_{RRM} | Repetitive peak off-state current Repetitive peak reverse current | $V_D = V_{DRM}$ $V_R = V_{RRM}$ | 125 | | | 160 | mA |
| I_{TSM} I^2t | Surge on-state current I^2T for fusing coordination | 10ms half sine wave $V_R=0.6V_{RRM}$ | 125 | | | 22.7 2576 | KA $A^2s \cdot 10^3$ |
| V_{TO} | Threshold voltage | | 125 | | | 1.48 | V |
| r_T | On-state slop resistance | | 125 | | | 0.23 | m Ω |
| V_{TM} | Peak on-state voltage | $I_{TM}=4000A$, $F=35KN$ | 125 | | | 2.40 | V |
| dv/dt | Critical rate of rise of off-state voltage | $V_{DM}=0.67V_{DRM}$ | 125 | | | 500 | V/ μ s |
| di/dt | Critical rate of rise of on-state current | $V_{DM}=67\%V_{DRM}$ to 3000A, Gate pulse $t_r \leq 0.5 \mu$ s $I_{GM}=1.5A$ | 125 | | | 1000 | A/ μ s |
| I_m | Reverse recovery current | $I_{TM}=1700A$, $t_p=1000 \mu$ s, di/dt=-20A/ μ s, VR=50V | 125 | | | 166 | A |
| t_{rr} | Reverse recovery time | | | | | 10 | μ s |
| Q_{rr} | Recovery charge | | | | | 836 | 880 |
| t_q | Circuit commutated turn-off time | $I_{TM}=1700A$, $t_p=1000 \mu$ s, $V_R=50V$ dv/dt=30V/ μ s, di/dt=-20A/ μ s | 125 | 50 | | 80 | μ s |
| I_{GT} | Gate trigger current | $V_A=12V$, $I_A=1A$ | 25 | 40 | | 450 | mA |
| V_{GT} | Gate trigger voltage | | | 0.9 | | 4.5 | V |
| I_H | Holding current | | | 20 | | 1000 | mA |
| V_{GD} | Non-trigger gate voltage | $V_{DM}=67\%V_{DRM}$ | 125 | 0.3 | | | V |
| $R_{th(j-h)}$ | Thermal resistance Junction to heatsink | At 180° sine, double side cooled Clamping force 35KN | | | | 0.016 | $^{\circ}C /W$ |
| F_m | Mounting force | | | 30 | | 40 | KN |
| T_{stg} | Stored temperature | | | -40 | | 140 | $^{\circ}C$ |
| W_t | Weight | | | | | 900 | g |
| Size | Package box size | | | | | 160 × 145 × 65 | mm |

PERFORMANCE CURVES FIGURE

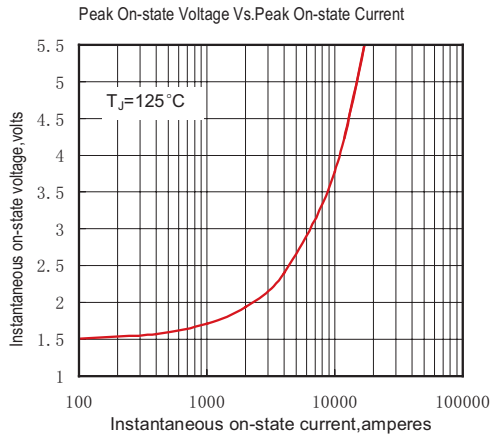

Fig.1

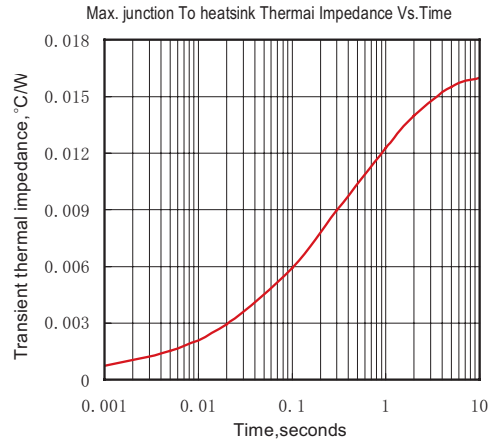

Fig.2

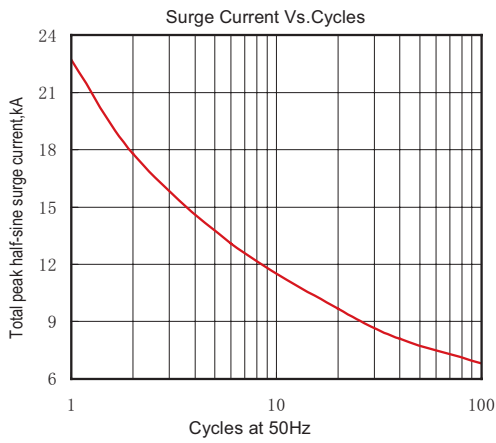

Fig.3

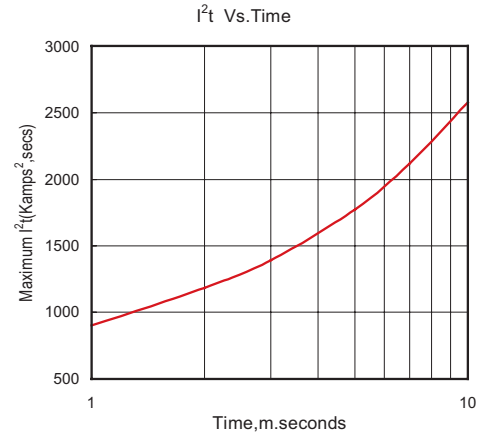

Fig.4

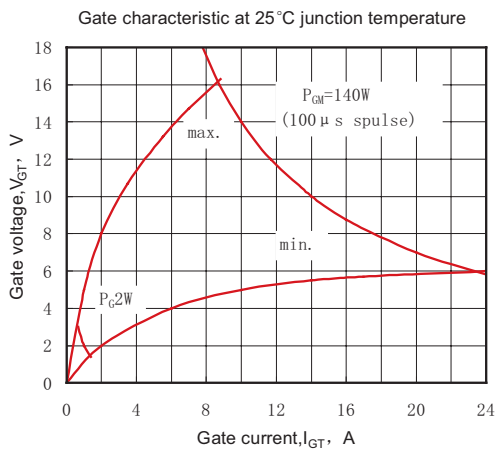

Fig.5

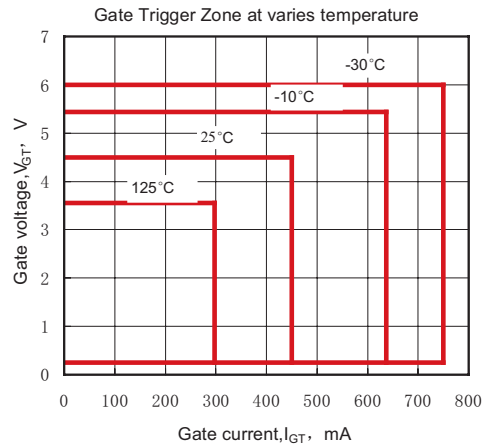
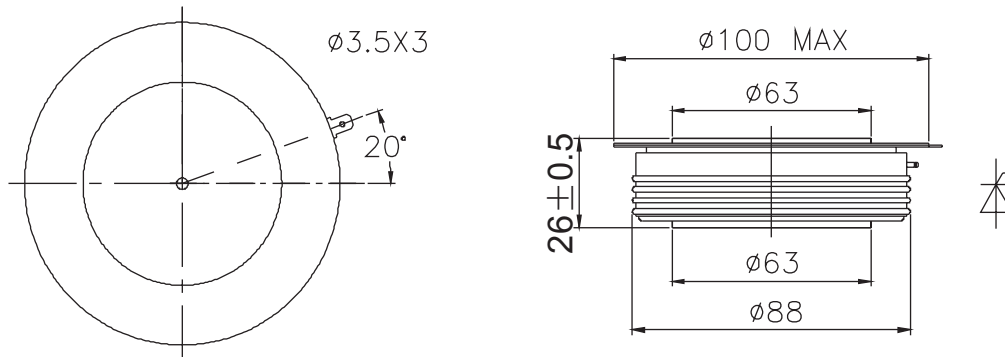

Fig.6

OUTLINE



YUEQING LIUJING RECTIFIER CO., LTD

Sale Department: Liujing Building, Yueqing City,
Zhejiang Province

Add: Wanao Industrial Zone, Yueqing city,
Zhejiang Province

Tel: 0086-577-62519692 0089-577-62519693

Fax: 0086-577-62518692

International Export: 0086-577-62571902

Technical Support: 0086-15868768965

After Service: 400-6606-086

<http://www.china-liujing.com>

<http://www.liujingdianqi.cn>

<http://www.cnrectifier.com>

<http://www.cnthyristor.com.cn>

MSN: thristors@hotmail.com

打造最具竞争力的电力半导体产品

To be the most competitive Power Semiconductor
Devices manufactory.

LIUJING reserves the right to change limits, test conditions and dimensions.

윤정은 이 칼타로그 중에 데이트, 테스트 조건, 외형사이즈에 대한 최종 해석권을 가지고 있습니다.